

Inline Angel Hair Trap

Designed to mount in the material stream to collect "angel hair", "streamers" or "snake skins" while allowing the pellets to pass through.

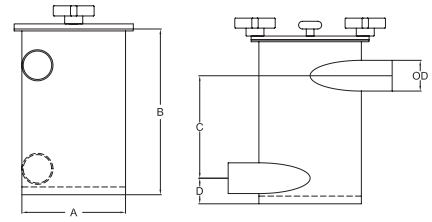

Standard Features

- Eliminate downtime caused by Angel Hair and Streamers
- The clear viewing cover for level indication can be quickly removed for clean out
- For use in vacuum lines and pressure conveying systems
- Three standard body sizes are 8", 10" and 18" with line sizes from 1.5" OD up to 6" OD
- Body constructed of 12 gauge 304 Stainless Steel
- Connects to line with compression couplings
- Black knobs standard

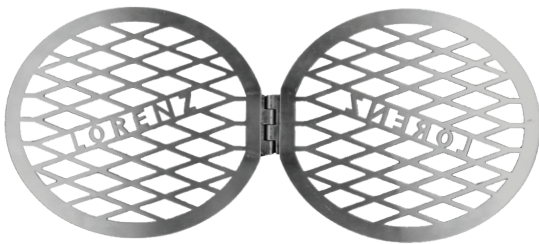

| OD | A | B | C | D |
|--------|-------|-------|-------|------|
| 1.5" | 8.00 | 10.75 | 6.50 | 2.00 |
| 2" | 8.00 | 10.75 | 6.50 | 2.00 |
| 2.5" | 10.00 | 16.00 | 10.56 | 2.50 |
| 3" | 10.00 | 16.00 | 10.00 | 2.50 |
| 3.5" | 10.00 | 16.00 | 9.88 | 2.88 |
| 4" | 10.00 | 16.00 | 9.88 | 3.13 |
| 4.5" | 10.00 | 16.00 | 9.88 | 3.13 |
| 5" | 18.00 | 23.50 | 15.75 | 3.50 |
| 5.563 | 18.00 | 23.50 | 14.50 | 4.00 |
| 6" | 18.00 | 23.50 | 14.38 | 4.13 |
| 6.625" | 18.00 | 23.50 | 14.44 | 4.31 |

All dimensions are approximate and subject to change.

Automated Inline Angel Hair Trap

Utilizing a combination of 2 Way Diverters and Inline Angel Hair Traps the process of cleaning angel hair from your line is automated eliminating downtime.

